

COMMERCIAL METAL FRAME INSTALLATION

WOOD STUD CONSTRUCTION

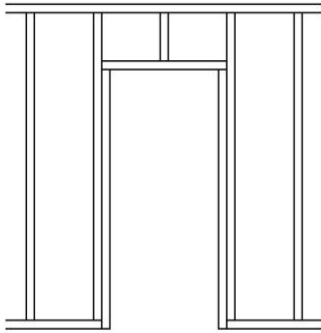

ROUGH STUD OPENING

Width=Nom. frame width +4-3/8"
min. to 4-3/4" max.(i.e. 3'0"
=40-3/8" min. to 4-3/4"
max.)

Height=Nom. frame height +2-1/4"
min. (i.e. 6'8"=82-1/4" min.)

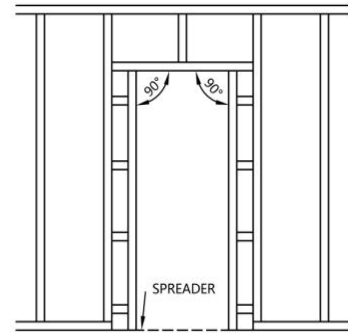
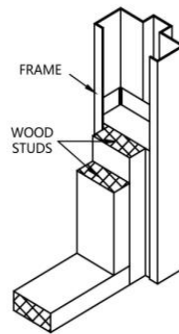

ROUGH STUD OPENING

(1) Insert a minimum of three anchors per jamb. Can't anchors in frame throat and tap in with a hammer. Place frame in rough stud opening. (2) Bend anchor tabs around stud leaving desired clearance between frame return and stud. (3) Set spreader and level frame. Shim under jambs if necessary. (4) Square and nail top anchors to studs on ONE SIDE ONLY. Check plumb and square and continue to nail balance of anchors to studs.

MASONRY CONSTRUCTION

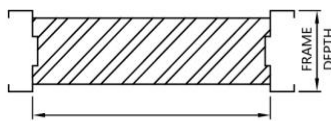

SPREADER

Typical wood spreader must be square and fabricated from lumber no less than 1" thick. Correct length is the door opening width between the jambs at the header. Cut clearance notches for frame stops. Spreader must be nearly as wide frame depth for proper installation.

I.e., Single door 3'0"=36"
Double door 6'0"=72"

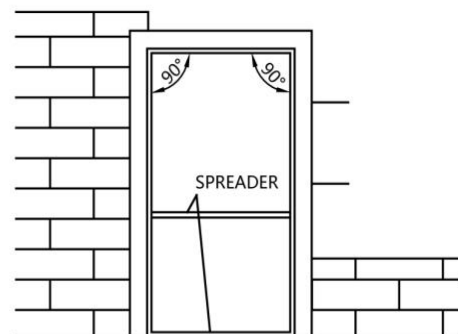
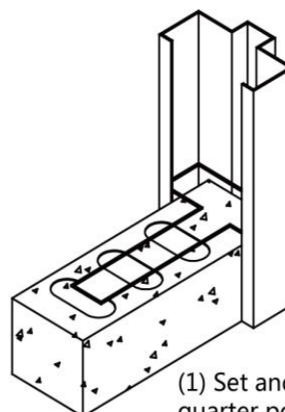

(1) Set and plum frame. (2) Install three anchors per jamb at quarter points as wall is laid up. Grout frame in the area of the anchors. (3) a second spreader is recommended at the mid point of the door opening to maintain the door opening dimension. (4) Continually check plum and square as wall progresses.